

US-CSH-06-F

Stainless Steel Security Housing



Interior /
Exterior

Durable
Housing

Vandal
Resistant

Vandal-Resistant Hardware

The US-CSH-06-F security housing is designed to house Commend's tamper/weather resistant substations in either interior or sheltered exterior locations. The housing is constructed of carbon steel and is designed to protect the flush-mounted station. This provides reliable and subtle housing for the Commend security substation. The US-CSH-06-F can be configured to accept a variety of Commend security substations.

Functions and highlights

Flush-mount housing

- Height: 11.75"
- Width: 8.5"
- Depth: 3.5"
- Weight: 10.5 lb
- Material: carbon steel

Optional Features

- Voltage: 120-240 VAC
- Combination blue beacon and strobe kit (low voltage)

Technical Data and System Requirements

Depending on desired Intercom (consult with Commend Americas sales for support).

Precautions

- When opening the stations ESD precautions must be observed.
- The stations may only be opened by authorized service engineers.

Measurements

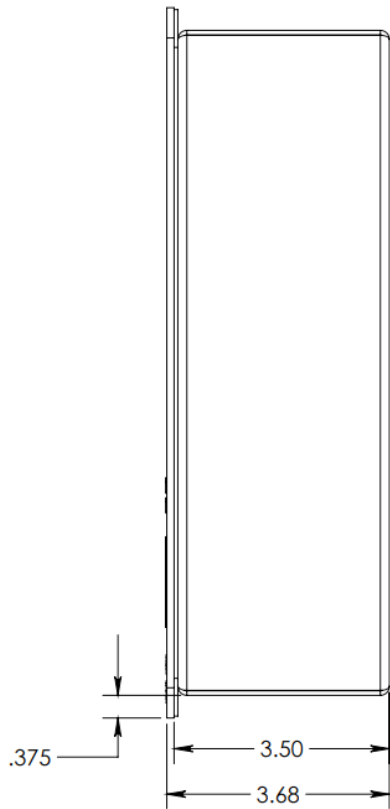

SIDE VIEW

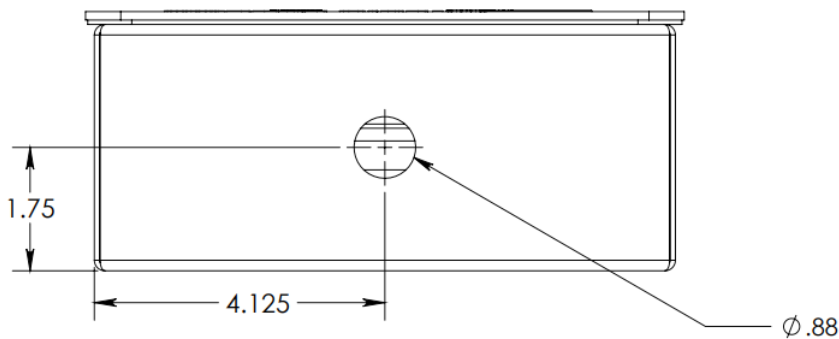

BOTTOM VIEW

Extent of Supply

- 1 security housing
- Installation screws

Applications

- Hospitals
- Parking garages
- Airports
- Jails / Correctional Facilities
- Toll booths / tunnels
- Schools / campuses
- Apartment complexes
- Mass transit

Benefits

- Weather / Vandal resistant
- Trim rings available to fit smaller substations
- Ideal for people in duress
- Durable housing
- Mass notification reliability
- Scream alarm feature in Commend Stations
- Separate strobe is available

