

Y-WS-BB

Vandal resistant housing with LED



Rugged
housing

Vandal
resistant
IK10

Modular
construction

Weather-
proof
IP65

Rugged stainless steel housing

The Y-WS-BB rugged housing is designed to be used with Commend's vandal resistant WS Series Intercom stations. Its size and the attention catching LED make it a highly visible security point for people in emergency situations. The LED supports 13 patterns. Furthermore it is equipped with a second LED for permanent operation, which is used to determine its location. The housing is made of stainless steel. Individual colour design of the housing, glass and labelling possible on request.

Features and highlights

- Modular construction, prepared for mounting all vandal resistant WS Series Intercom stations
- Attention catching LED behind opaque glass
- 13 flashing patterns
- Additional permanent light for localization
- Vandal resistant rugged housing
- Standard finish in RAL 9007 (gray aluminium)
- Optional text available (Emergency, HELP, INFO, SOS or Security)
- Individual colour design of the housing, glass and labelling possible on request

Y-WS-BB

Technical specifications

Technical data

IP rating:	IP65
Mechanical impact resistance:	IK10 (according to EN 60529)
Power consumption flashlight:	max. 9 W
Power supply:	12 VDC
Dimensions (W x H x D):	400 x 164 x 50 mm (15.75 x 6.46 x 1.97 in)
Weight:	excluding package: 2,275 g (5.0 lbs) including package: 2,775 g (6.1 lbs)
Housing colour:	RAL 9007 ¹⁾
Colour design:	text and glass: blue ¹⁾
Labelling ²⁾:	Emergency, HELP, INFO, SOS or Security
Material:	stainless steel

¹⁾ Individual colour design available on request

²⁾ Available on request



Extent of supply

- Vandal resistant housing with LED behind opaque glass
- Polycarbonate box
- 3 x IP66 cable feed through
- Wall mount kit (screws, dowels, gasket rings and washers)
- Cable fixing brackets (incl. screws)
- Short reference

Y-WS-BB

Installation instructions

Dimensions front panel

Measuring units in mm (in), not to scale!

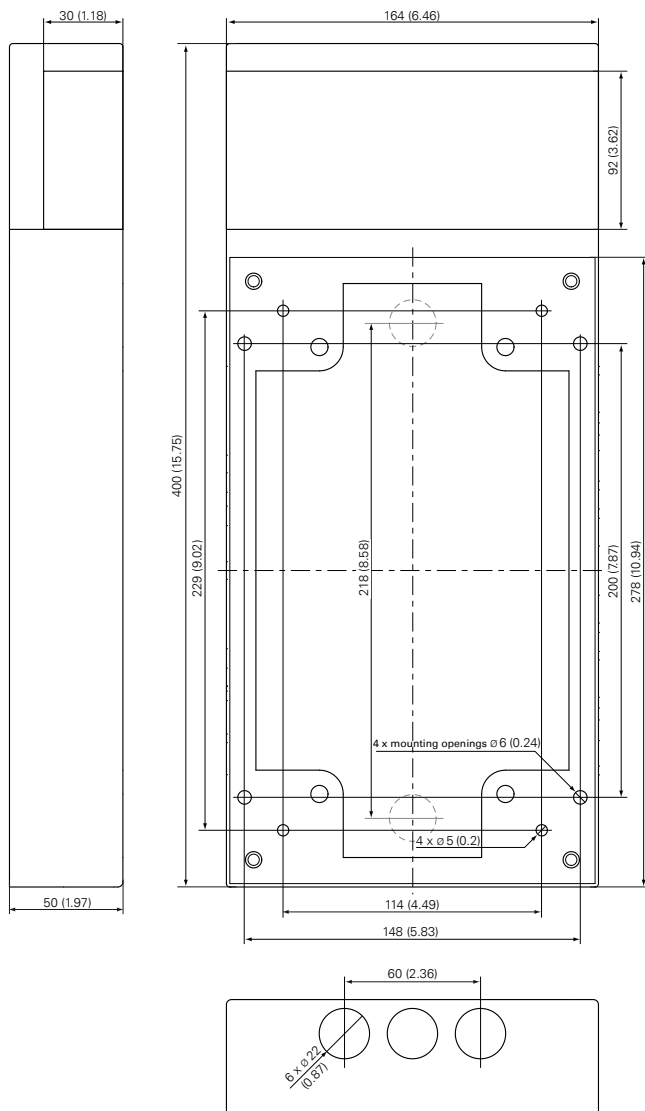

Mounting instructions

- Observe the country specific standards for installation, mounting and configuration.
- When opening the station, ESD precautions must be observed.
- The housing may only be installed by authorised service engineers.

Connection

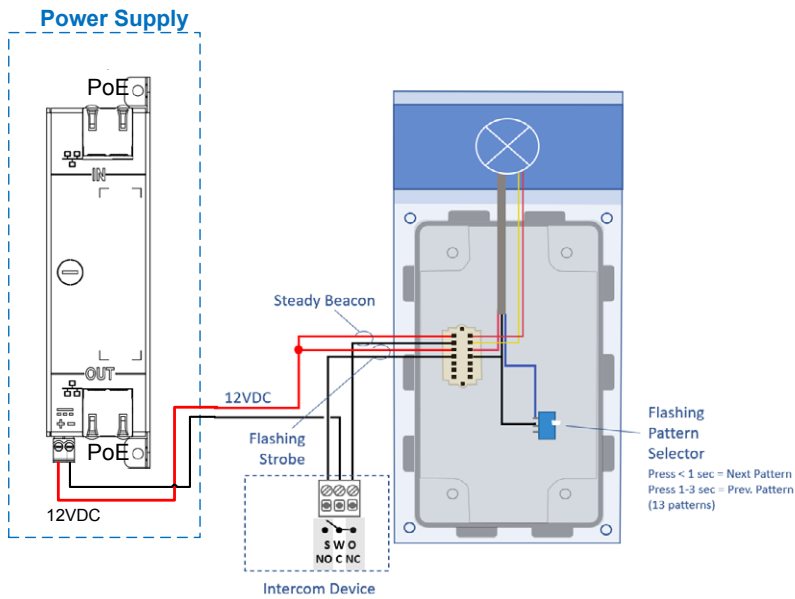

Flashlight configuration

The junction box is delivered along with four wires for connection¹⁾:

- +/- for the permanent light
- +/- for the light with 13 flashing patterns

Configuration of the flashlight is as follows:

1. Connect the 12 VDC power supply to the designated terminals (see "Connection").
2. Set LED pattern using the button:
 - For next pattern, press switch for less than 1 second.
 - For previous pattern, press switch between 1 and 3 seconds.
3. The last set pattern is maintained automatically.
4. The flashlight is controlled via the output of an Intercom station (see "Connection").

¹⁾Wiring Schemes are just suggestions.

Quality tested. Reliable. Smart.

COMMEND products are developed and manufactured by Commend International in Salzburg, Austria.

The development and manufacturing processes are certified in accordance with **EN ISO 9001:2015**.



The technical data contained herein has been provided solely for informational purposes and is not legally binding. Subject to change, technical or otherwise. lolP®, OpenDuplex® and Commend® are trademarks registered by Commend International GmbH. All other brands or product names are trademarks or registered trademarks of the respective owner and have not been specifically earmarked.

A strong worldwide network

COMMEND is represented all over the world by local Commend Partners and helps to improve security and communication with tailored Intercom solutions.

www.commend.com